

CENTER TOWNSHIP SECTION 11 R10- TWP 6 MORGAN COUNTY, OH

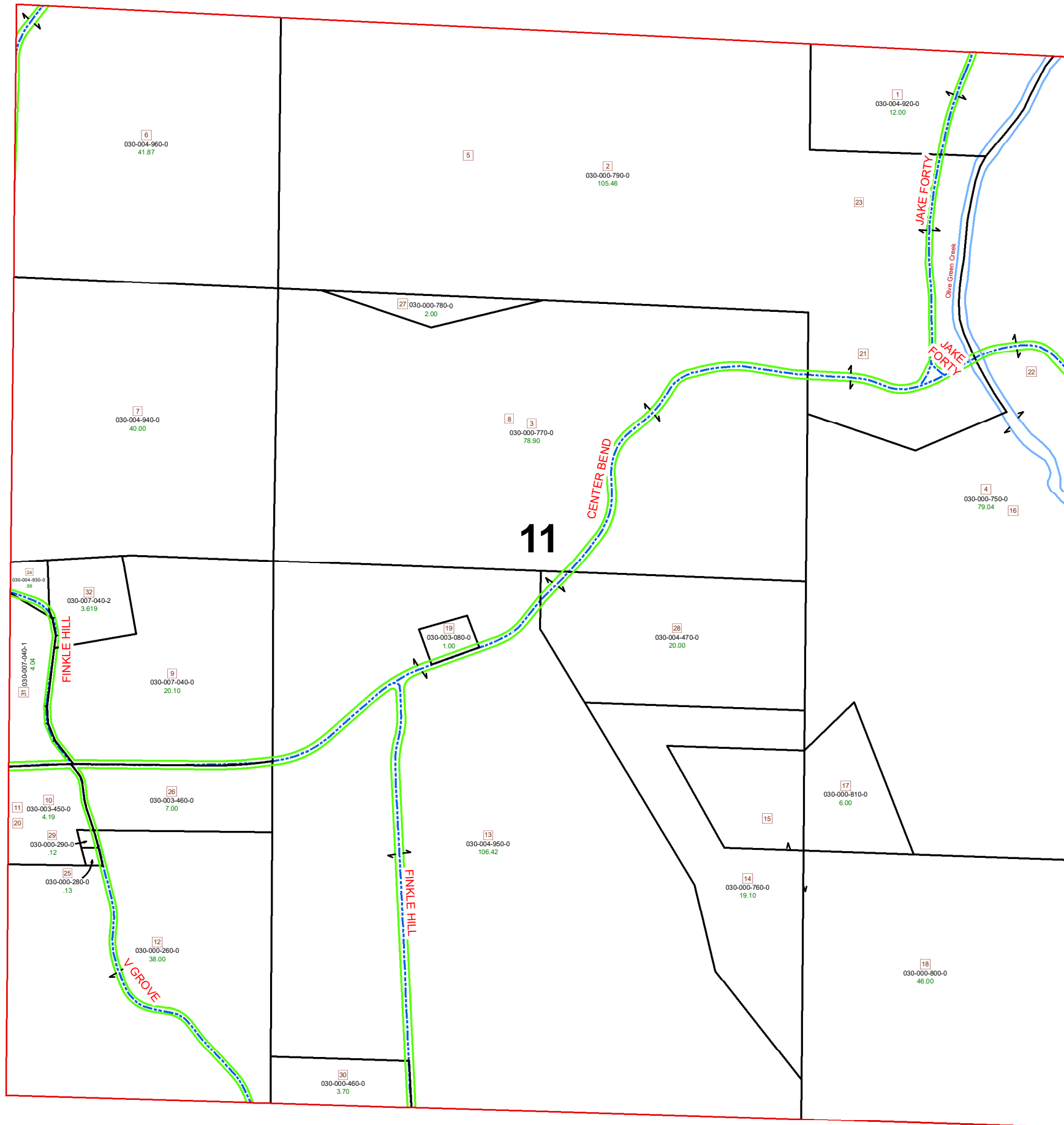

PIN	VOL	PAGE	Owner	LegalDescr	Acres
030-000-280-0	OR219	1659	BARNHART ALICE	R10 T06 S11 SD 25	0.13
030-000-290-0	OR219	1659	BARNHART ALICE	R10 T06 S11 SD 29	0.12
030-003-450-0	OR115	146	BARNHART JAMES E JR	R10 T06 S11 SD 10-1	4.19
030-003-460-0	OR115	146	BARNHART JAMES E JR	R10 T06 S11 SD 26	7
030-000-800-0	OR230	1	CNX LAND LLC	R10 T06 S11 SD 15-1	46
030-000-760-0	OR230	1	CNX LAND LLC	R10 T06 S11 SD 14 F	19.1
030-000-810-0	OR230	1	CNX LAND LLC	R10 T06 S11 SD 17 F	6
030-004-950-0	OR230	1	CNX LAND LLC	R10 T06 S11 SD 13 P	106.42
030-004-930-0	OR230	1	CNX LAND LLC	R10 T06 S11 SD 24 H	0.88
030-000-790-0	OR230	1	CNX LAND LLC	R10 T06 S11 SD 2-5-	105.46
030-000-770-0	OR230	1	CNX LAND LLC	R10 T06 S11 SD 3-8	78.9
030-000-780-0	OR230	1	CNX LAND LLC	R10 T06 S11 SD 27 C	2
030-004-940-0	OR230	1	CNX LAND LLC	R10 T06 S11 SD 07 H	40
030-000-750-0	OR230	1	CNX LAND LLC	R10 T06 S11 SD 4-16	79.04
030-004-920-0	OR230	1	CNX LAND LLC	R10 T06 S11 SD 01 P	12
030-004-960-0	OR230	1	CNX LAND LLC	R10 T06 S11 SD 06	41.87
030-004-470-0	OR64	571	KELBY GWENDOLYN S	R10 T06 S11 SD 28	20
030-000-460-0	OR81	472	LEMASTERS TERRY L & KRISTI	R10 T06 S11 SD 30	3.7
030-007-040-1	OR168	191	MORRIS JOHN L	R10 T06 S10 SD 31	4.04
030-003-080-0	OR206	1781	MORRIS TIMOTHY I	R10 T06 S11 SD 19	1
030-007-040-2	OR218	3405	PERONI AMANDA JO	R10 T06 S11 SD 32	3.619
030-007-040-0	OR204	1996	PHILLIS ROGER TOD-AMANDA	R10 T06 S11 SD 09 E	20.091
030-000-260-0	OR115	150	TULLIUS ELIZABETH L & CARO	R10 T06 S11 SD 12 L	38

 Sections	 Hydro	 Parcels
Boundaries	 Lot	 Roads
Type	 Parcel	 ROW
 Hidden		

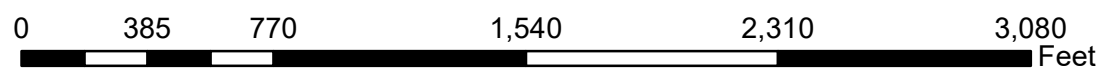

Disclaimer: The information that these maps contains is or reference purposes only. Please bring any erros to the attention of the Engineer's Office staff.
Thank you

Source: Morgan County Engineer's Office
Author: Marcia Wolfe
Date: 3/13/2020